

# **NEW** Windows & Doors™

## Replacing an IG Glass Unit

Replacing an IG glass unit is rated as a Moderate repair. This procedure is performed entirely within the home.

Approximate Time Required:

20 Minutes

Level of Difficulty:

Easy Moderate Difficult

### Tools Needed:

1-1/2" Spatula

1/2" Chisel / Channel Lock Pliers

Mallet

Silicone

### Step 1

On a slider style window, remove the sash and perform this process on the floor. On a casement style window, the procedure may be performed with the sash still in the window frame. Using a chisel, place the square edge into the groove between the glazing stop and the sash frame ([pic. 1a](#)) Start at the end and begin by angling the chisel downward and tapping with the palm of your hand ([pic. 1b](#)). This will loosen the stop. Once you have done this, you can pull out the remainder by hand ([pic. 1c](#)).

Picture 1a



Picture 1b



Picture 1c

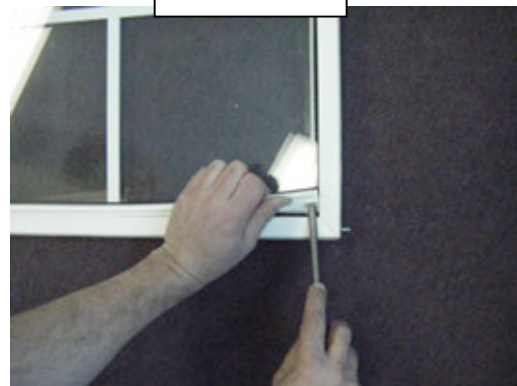

### **Step 2**

Continue with the other stops until they have all been removed.

### **Step 3**

Using the spatula, slide it in between the glass and the black rubber flex on the exterior side of the sash. Now pull the spatula across the sash. This will break the silicone seal from the factory. Be extra careful not to damage the black flex as this will require a replacement. Once the spatula has been run across all four sides, the glass is ready to be removed.



### **Step 4**

**THIS STEP SHOULD BE TAKEN WITH EXTRA CAUTION**

With the aid of an assistant, someone will push on the perimeter of the glass from the outside. The assistant should be inside to stop the glass from falling to the ground. You may have to use considerable force to push on the glass. If you hear a cracking sound, stop immediately and assess the situation.



### **Step 5**

After you have removed the sealed unit, clean all remnants of the silicone that was placed by the factory and ensure that the glazing blocks are still in their original positions.



### **Step 7**

Apply a fresh bead of silicone around the perimeter of the sash over the black flex where the sealed unit will rest. Do not apply too much as this will cause the excess to spread out onto the glass surface.

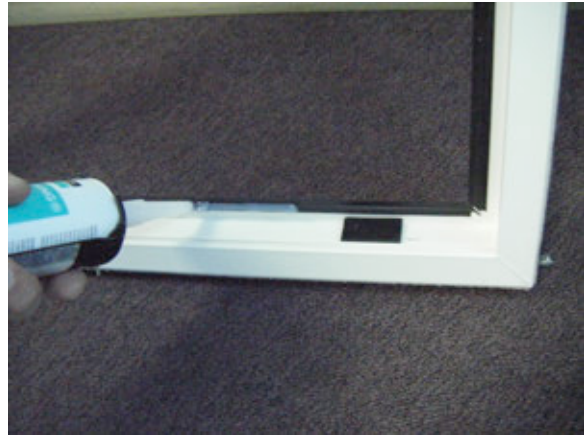

### **Step 8**

Carefully rest the bottom edge of the replacement sealed unit into the sash and gently seat it. Press down around the perimeter with your fingers to ensure good contact between the sealed unit and the sash.



### **Step 9**

Using a mallet, tap in the glazing stop starting at one end first. Proceed to the other end and tap that side in. slowly work your way towards the centre of the sash.



### **Step 9a**

You may also use a large set of Channel Locks that have protective tape applied to the teeth of the jaws.



### **Step 10**

Continue applying the remaining glazing stops until completed using the same process as previously mentioned.



### **Step 11**

During the process of tapping in the glazing stops, the sash may have bowed outwards. To correct this, just tap on the outside of the sash rail to make it level again.

